

**PROPRIETARY AND CONFIDENTIAL**

THE INFORMATION CONTAINED IN THIS DRAWING IS THE SOLE PROPERTY OF DYTRAN INSTRUMENTS INC. ANY REPRODUCTION IN PART OR AS A WHOLE WITHOUT THE WRITTEN PERMISSION OF DYTRAN INSTRUMENTS, INC. IS PROHIBITED

**REVISIONS**

REV	ECN	DESCRIPTION	BY/DATE	CHK	APPR
B	7027	ADDED NOTE 4	JS 08/18/10		

MODEL	SENSITIVITY
3273A1T	10mV/G
3273A2T	100mV/G
3273A4T	50mV/G

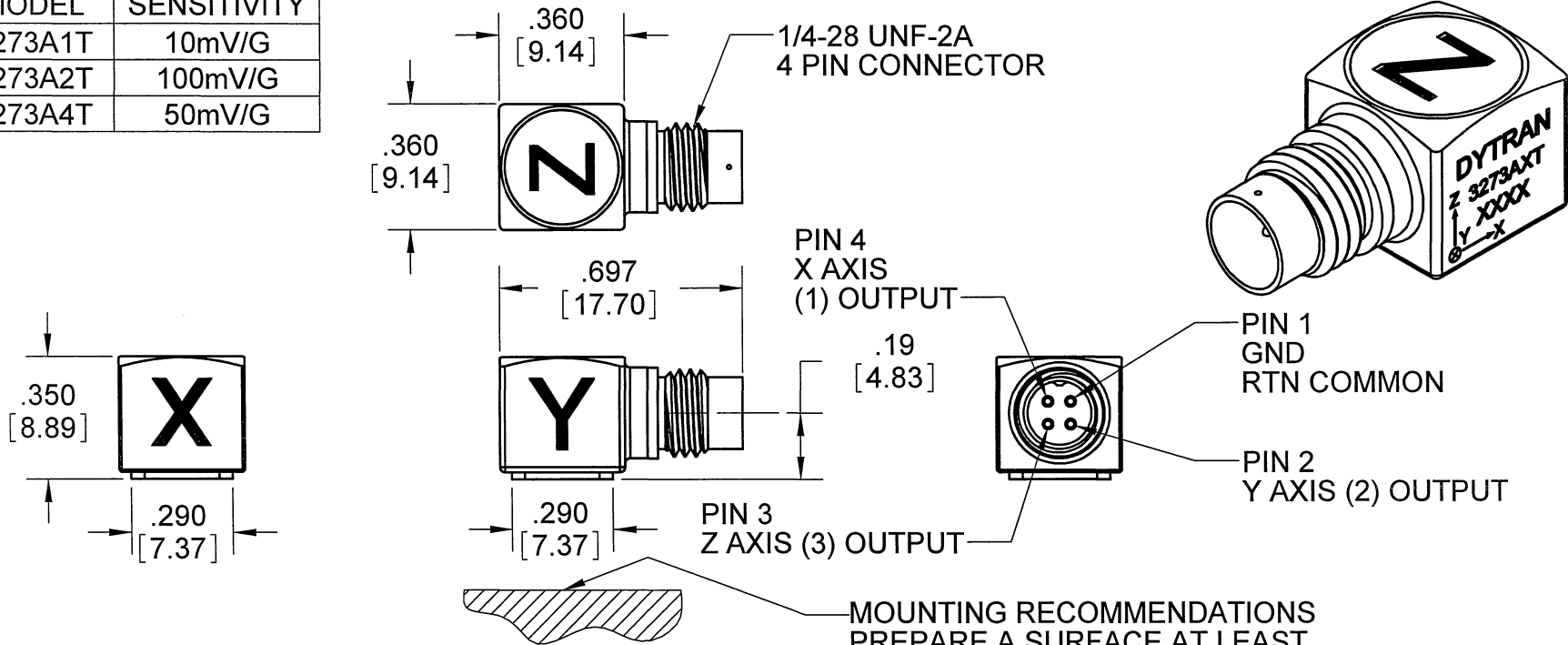

4. TO MATE CABLE TO CONNECTOR INSERT PLUG AND ENGAGE KEYWAY BEFORE TURNING COUPLING NUT.
  3. HOUSING/CONNECTOR MATERIAL: TITANIUM
  2. ARROWS INDICATE DIRECTIONS OF ACCELERATION FOR POSITIVE OUTPUT.
  1. WEIGHT: 3.0 GRAMS APPROXIMATELY
- NOTES: UNLESS OTHERWISE SPECIFIED.

MOUNTING RECOMMENDATIONS  
 PREPARE A SURFACE AT LEAST  
 .300 BY .300. SURFACE FLATNESS MUST  
 BE EQUAL OR BETTER THAN .0001 TIR.  
 USE ONE DROP OF CYANOACRYLATE  
 TO MOUNT THE ACCELEROMETER.

UNLESS OTHERWISE SPECIFIED: INTERPRET DIM & TOL PER ASME Y14.5M - 1994. REMOVE BURRS. COUNTERSINK INTERNAL THDS 90° TO MAJOR DIA. CHAM EXT THDS 45° TO MINOR DIA. THD LENGTHS AND DEPTHS ARE FOR MIN FULL THDS. THDS PER MIL-S-7742. DIMENSIONS APPLY AFTER FINISHING.	
UNLESS OTHERWISE SPECIFIED: DIMENSIONS ARE IN INCHES. DIMENSIONS IN BRACKETS [ ] ARE IN MILLIMETERS TOLERANCES ARE: INCHES    METRIC    ANGLES .XX ± .03    X ± 0.8    ± 1° .XXX ± .010    XX ± 0.25	
MATERIAL	
FINISH	
DO NOT SCALE DRAWING	

ALL MACHINED SURFACES TOTAL RUNOUT WITHIN .005.  
 BREAK SHARP EDGES .005 TO .010.  
 MACHINED FILLET RADII .005 TO .015.  
 WELDING SYMBOLS PER AWS A2.4.  
 ABBREVIATIONS PER MIL-STD-12.

CONTRACT NO.		
APPROVALS		DATE
ORIG	R.A.	05/05/09
CHK	EP	05/11/09
APP	DV	05/12/09
APP		

**DYTRAN** INSTRUMENTS, INC. Chatsworth, CA

**MASTER ONLY IF IN RED**

TITLE: **OUTLINE/INSTALLATION DRAWING, MODEL 3273AT SERIES**

SIZE	CAGE CODE	DWG. NO.	REV
<b>A</b>	<b>2W033</b>	<b>127-3273AT</b>	<b>B</b>

SCALE: 4:1    SOLIDWORKS    SHEET 1 OF 1

# 3273A4T

# PERFORMANCE SPECIFICATION

REV J, ECN 11192, 07/25/14

Accelerometer, Triaxial, IEPE



Actual Size

- ULTRA LOW FREQUENCY RESPONSE
- ULTRA LOW NOISE LEVEL
- WEIGHT ONLY 3 GRAMS

### PHYSICAL

	ENGLISH		SI	
Weight	0.105	oz	3.0	grams
Mounting	Adhesive		Adhesive	
Connector [1]	4-pin		4-pin	
Housing	Type	Ti-6 AL-4V	Type	Ti-6 AL-4V
	Material	Ti-6 AL-4V	Material	Ti-6 AL-4V
Sensing Element	Isolation	Case ground	Isolation	Case ground
	Material	Ceramic	Material	Ceramic
Mode	Shear		Shear	

### PERFORMANCE

	ENGLISH		SI	
Sensitivity, ±10% [2]	50	mV/g	5.10	mV/m/s <sup>2</sup>
Acceleration Range	100	Gpeak	981	m/s <sup>2</sup> peak
Frequency Range, ±15%	.3-10,000	Hz	.3-10,000	Hz
Frequency Range, ± 5%	.5 - 3000	Hz	.5 - 3000	Hz
Resonance Frequency	>24	kHz	>24	kHz
Linearity [3]	1	%F.S.	1	%F.S.
Phase Response, ± 5°	2.3 to 3000	Hz	2.3 to 3000	Hz
Transverse Sensitivity Max	5	%	5	%
Noise floor, Max	0.002	Grms	0.020	m/s <sup>2</sup> rms
Spectral Noise	1Hz	525 μGrms/sqr(Hz)	5150	μm/s <sup>2</sup> rms/sqr(Hz)
	10Hz	101 μGrms/sqr(Hz)	991	μm/s <sup>2</sup> rms/sqr(Hz)
	100Hz	50 μGrms/sqr(Hz)	491	μm/s <sup>2</sup> rms/sqr(Hz)
	1000Hz	16 μGrms/sqr(Hz)	157	μm/s <sup>2</sup> rms/sqr(Hz)
	10000Hz	10 μGrms/sqr(Hz)	98	μm/s <sup>2</sup> rms/sqr(Hz)

### ELECTRICAL

	ENGLISH		SI	
Supply Current Range [4]	2 to 20	mA	2 to 20	mA
Compliance Voltage Range	+18 to +30	VDC	+18 to +30	VDC
Output Impedance, Typ.	100	Ω	100	Ω
Output Bias Voltage	11 - 13	VDC	11 - 13	VDC
Discharge Time Constant.	0.5 to 1.5	sec	0.5 to 1.5	sec

### ENVIRONMENTAL

	ENGLISH		SI	
Shock Max	5000	g pk	49050	m/s <sup>2</sup>
Vibration Max	3000	g pk	29430	m/s <sup>2</sup>
Operating Temperature	-60 to +185	°F	-51 to +85	°C
TEDS Operation Temperature	-40 to +185	°F	-40 to +85	°C
Seal	Hermetic		Hermetic	
Magnetic Sensitivity at 100 Gauss	0.000013	g/Gauss	0.00013	m/s <sup>2</sup> /Gauss
Base Strain Sensitivity	0.06	g/με	0.59	m/s <sup>2</sup> /με
TEDS feature	IEEE 1451.4		IEEE 1451.4	

### This family also includes:

Model	Sensitivity (mV/g)	Range (Gpeak)	Resolution (Grms)	Oper. Temp(°F)	TC
3273A1T	10	500	0.003	-60 to +225	0.5 - 1.5
3273A2T	100	50	0.00095	-60 to +165	0.5 - 1.5

Please, refer to the performance specifications of the products in this family for detailed description

### Supplied Accessories:

- 1) Accredited calibration certificate (ISO 17025)

### Notes:

- [1] Glass to metal Seal connector. Mates with Dytran cable model 6811AXX or 6824AXX (XX=length in feet)
- [2] Measured at 100 Hz, 5 Grms per ISA RP 37.2
- [3] Linearity is % of specified full scale (or any less full-scale range), zero-based best fit straight line method.
- [4] Do not apply power to this device without current limiting, 20mA Max, to do so will destroy the integral IC amplifier
- [5] In the interest of constant product improvement, we reserve the right to change specifications without notice

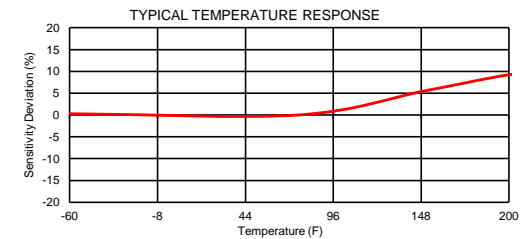
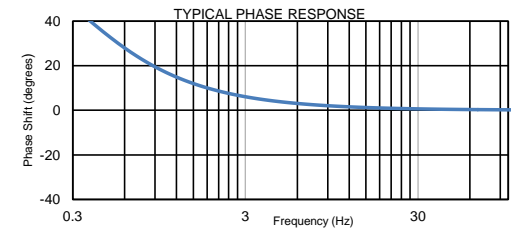
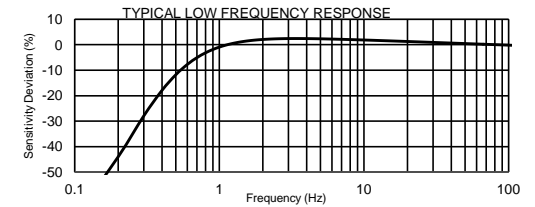
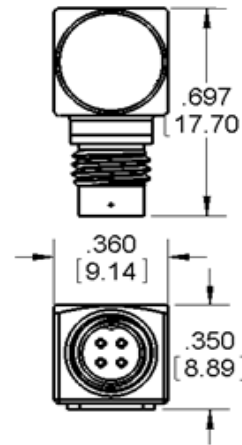

Units on the line drawing are in inches, units in brackets are in millimeters. Refer to 127-3273AT for more information.



21592 Marilla Street, Chatsworth, California 91311 Phone: 818.700.7818 Fax:818.700.7880  
[www.dytran.com](http://www.dytran.com) For permission to reprint this content, please contact [info@dytran.com](mailto:info@dytran.com)